

SECTION 10 T.21S. R.12W. W.M.
DOUGLAS COUNTY

21 12 10

THIS MAP WAS PREPARED FOR
ASSESSMENT PURPOSE ONLY.

1"=400'

SEE MAP 21 12 3

SEE MAP 21 12 9

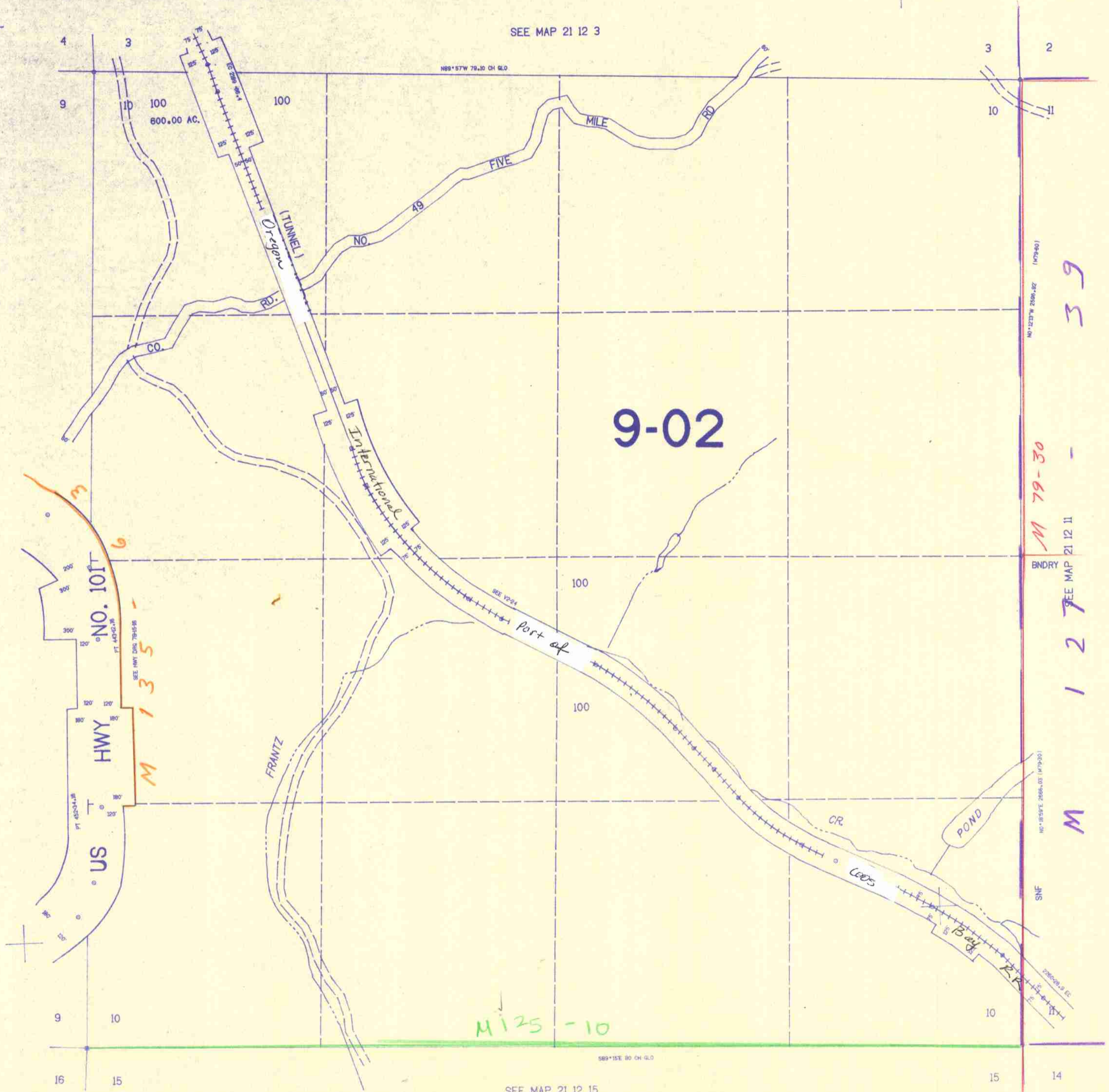

SEE MAP 21 12 15

21 12 10

11/02
88