

THIS MAP WAS PREPARED FOR ASSESSMENT PURPOSE ONLY.

SECTION 35 T.19S. R.10W. W.M.  
DOUGLAS COUNTY

19 10 35

1" = 400'

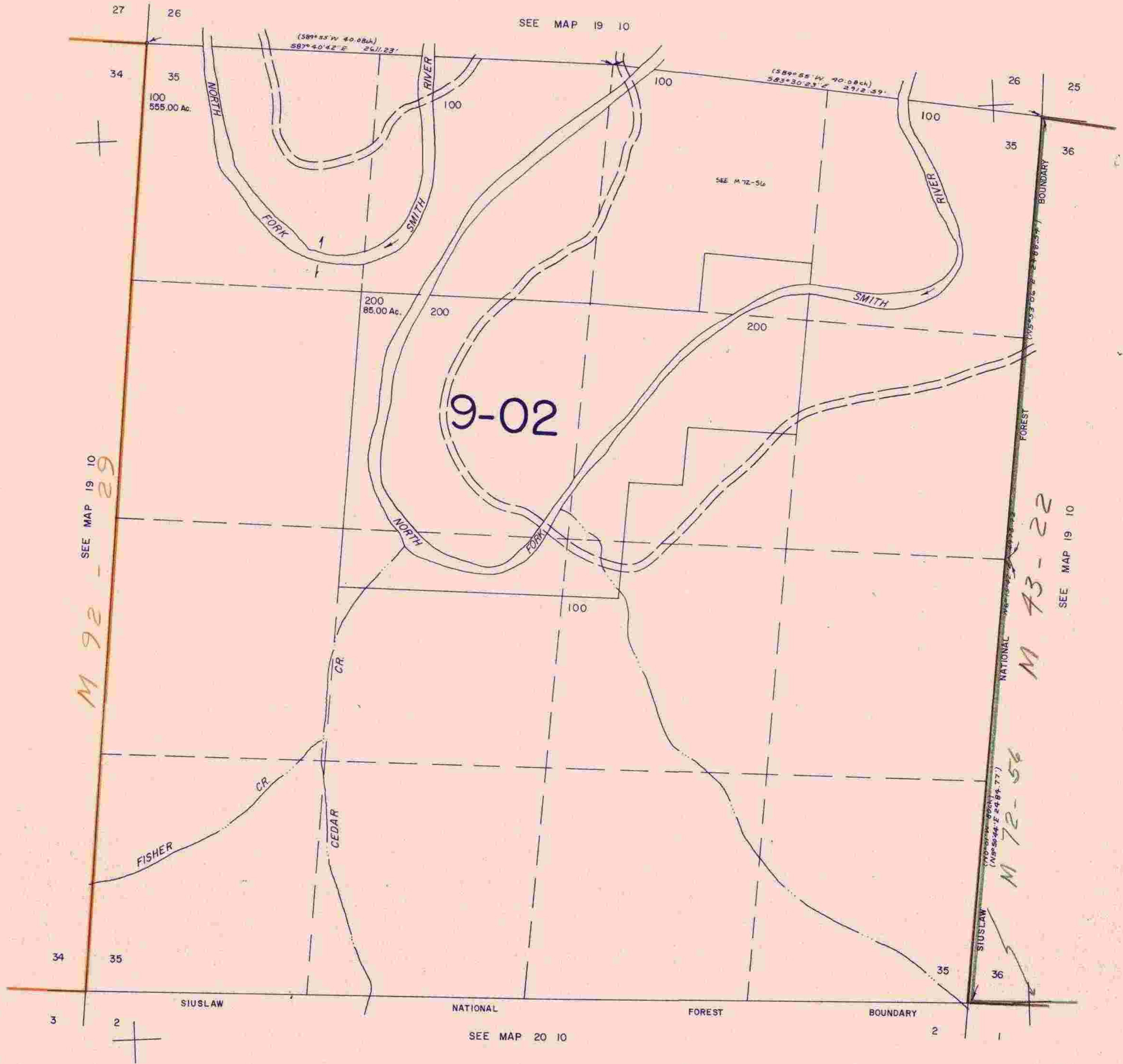

SEE MAP 19 10  
M 92 - 29

SEE MAP 19 10  
M 73-22

SEE MAP 19 10  
M 72-56

819,000

1,117,000

19 10 35

3/8/28